

In-line socket XELA-4

For mounting on vertical printed circuit boards, touch-protected and insulated according to IEC/EN61010-1. The socket is directly soldered

onto printed circuit boards. Fixed Ø 4 mm socket, to fit spring-loaded Ø 4 mm plugs with rigid insulating sleeve. Machined brass.

Connection: Ø 2 mm round pin and contacts for mounting on printed circuit boards.

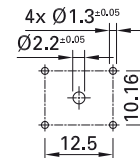
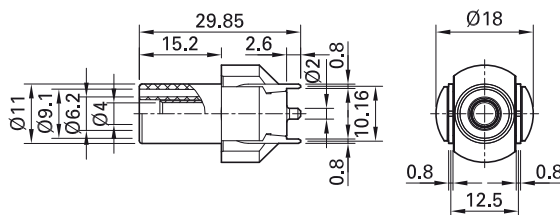

Panel drilling

Order No.	Type	Rated voltage/current		*Standard colors
66.9032-*	XELA-4	1000 V, CAT III / 24 A 600 V, CAT IV / 24 A	Au	21 22



Assembly instructions MAH565

www.staubli.com/electrical



Optional colors 23 24

Further information, page 6

Binding post PK4-T

Insulated, Ø 4 mm, rigid, and insulated head undetachable. Ø 2.5 mm cross hole for quick wire connection. Machined brass.

For mounting, with anti-rotation lug, in front panels up to 4 mm thick.

Connection: Threaded bolt M4.

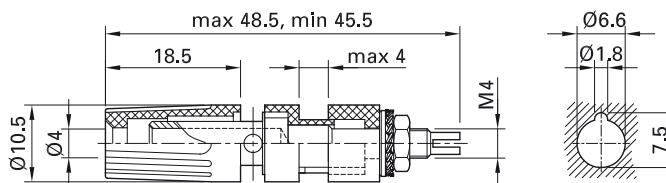

Order No.	Type	Rated voltage/current		*Standard colors
23.0330-*	PK4-T	30 VAC / 35 A 60 VDC / 35 A	Ni	20 21 22 23 24 25 29