

# Connecting plugs

## Connecting plug KS2-...

Insulated, Ø 2 mm, with rigid Ø 2 mm socket in handling part.

KS2-6L/A



KS2-6L/N

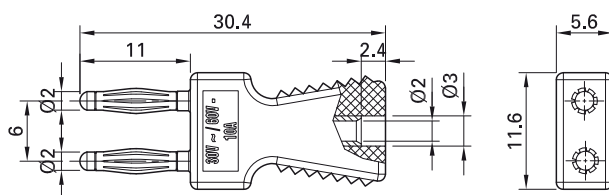
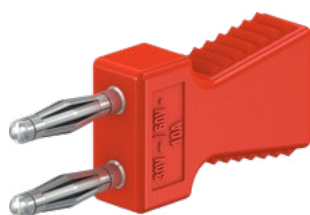

KS2-12L/A

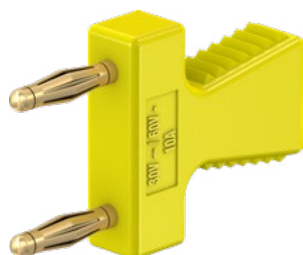

KS2-12L/N

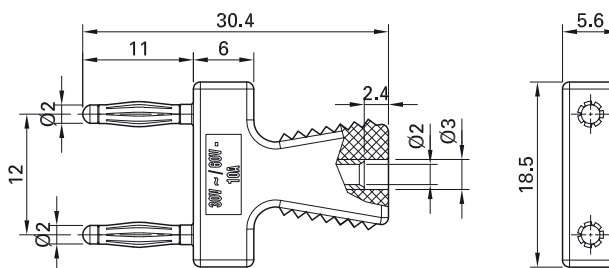

Order No.	Type	Rated voltage/current	Plug spacing	Suitable for		*Standard colors
63.9352-*	KS2-6L/A	30 VAC / 10 A 60 VDC / 10 A	6 mm	BL2-6/20/A	Au	21 22
63.9353-*	KS2-6L/N	30 VAC / 10 A 60 VDC / 10 A	6 mm	BL2-6/20/A	Ni	21 22
63.9354-*	KS2-12L/A	30 VAC / 10 A 60 VDC / 10 A	12 mm	BL2-12/20/A	Au	21 22 23 24 25
63.9355-*	KS2-12L/N	30 VAC / 10 A 60 VDC / 10 A	12 mm	BL2-12/20/A	Ni	21 22 23 24 25

Our Ø 2 mm connecting plugs KS2-..L.. are equipped with the tried and tested MULTILAM, and make a vibration-proof contact. Together with the socket strips BL2-... (page 33), they are ideally suited

for the saving of space in applications such as panels for testing and servicing in the aviation industry. The gold-plated versions offer a very low contact resistance and extremely high resistance to corrosion.



Optional colors 23 24 25 28 29

Further information, page 6